



2. Machine specifications

2. Machine specifications

2.1 Specification table

Description	Unit	Specifications	
		Lynx 200A	Lynx 200B
Capacity :			
Swing over bed	mm(in.)	460(18.11)	
Swing over saddle	mm(in.)	350(13.78)	
Recom. machining dia.	mm(in.)	165(6.50)	210(8.27)
Max. machining dia.	mm(in.)	280(11.02)	
Max. work length	mm(in.)	300(11.81)	
Draw tube dia.	mm(in.)	45(1.77)	52(2.05)
Travels :			
X axis	mm(in.)	160(20+140) {630(0.79+5.51)}	
Z axis	mm(in.)	330(13.00)	
Spindle :			
Chuck dia.	mm(in.)	169(6.65)	210(8.27)
Speed range	rpm	50-5,000	40-4,000
Spindle nose	ASA#	A2-5	A2-6
Spindle bore dia.	mm(in.)	53(2.09)	62(2.44)
Bearing dia.(Front)	mm(in.)	90(3.54)	100(3.94)
Turret :			
No. of tool stations(Type)	st.	10(Base holder)	
OD tool height	mm(in.)	25(1")	
Boring bar dia.	mm(in.)	Ø40(1.5")	
Indexing time	sec	0.15(1st. swivel)	
Freedrates :			
Rapid traverse	mm/min	X : 20,000/Z : 24,000	
Cutting feed	mm/rev	X, Z : 0.001~500.000	
Tail stock(Optional) :			
Quill dia.	mm(in.)	65(2.56)	
Quill bore taper	MT#	MT#4	
Quill travel	mm(in.)	80(3.15)	



2. Machine specifications

Description	Unit	Specifications	
		Lynx 200A	Lynx 200B
Motor :			
Spindle(Cont./30min)	kW	5.5/7.5(Opt. 5.5/7.5 HTM)	
Feed drives	kW	X : 1.4 / Z : 1.4	
Coolant pump	kW	0.24	
Power requirements :	kVA	25	
Machine size :			
Height	mm(in.)	1,550(61.02)	
Floor space	mm(in.) x mm(in.)	1,620(63.78) x 1,590(62.60)	
Weight(W/CNC System)	kgf	3,170	
CNC System :		FS21T-B(Opt. M50L)	



2. Machine specifications

2.2 Dimensional drawings

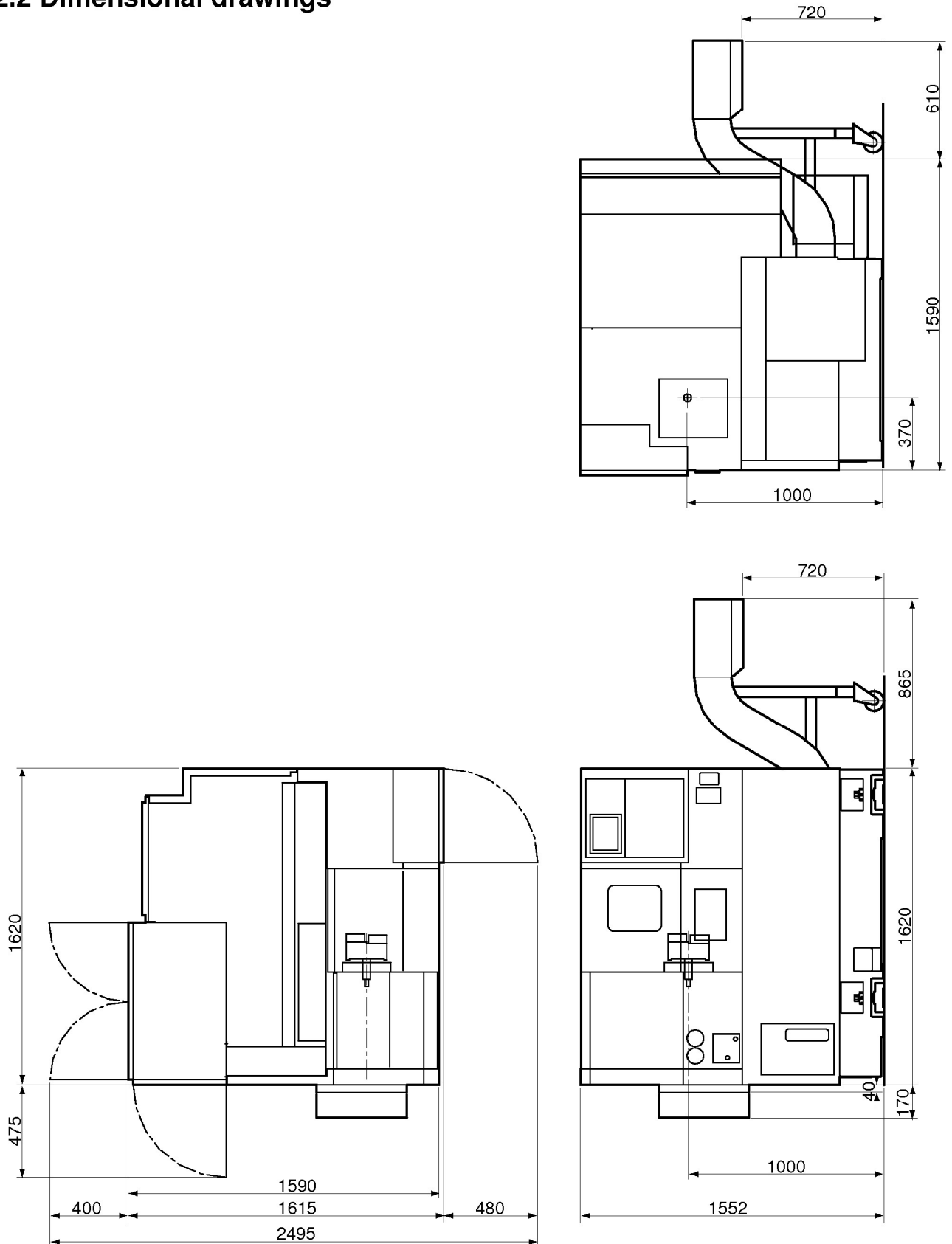

Fig. 2-1 Dimensional drawings